



### 6/2A Campbell Parade Manly Vale NSW

2  2  2 

Basking in radiant northerly sunshine with enchanting views over the adjoining Warringah Golf Course, this sleek contemporary garden apartment offers the ultimate combination of luxury, tranquillity and convenience. Forming part of the exclusive 'Augusta' security building, its private and peaceful setting is only a short breath away from Westfield Warringah Mall, B-line city buses and a selection of pristine beaches.

- Set right on the golf course to a picturesque landscaped backdrop
- Sweeping open plan living and dining space with tranquil outlook
- Glass sliders open to a wide covered sunny terrace with golf course views
- Sleek open plan stone kitchen with Miele appliances gas cooktop & convection microwave

**View** : <https://www.firstnationalmanly.com.au/lease/nsw/northern-beaches/manly-vale/residential/apartment/7791164>



**Giulia Ferguson**  
9966 5577



(Not In Position)

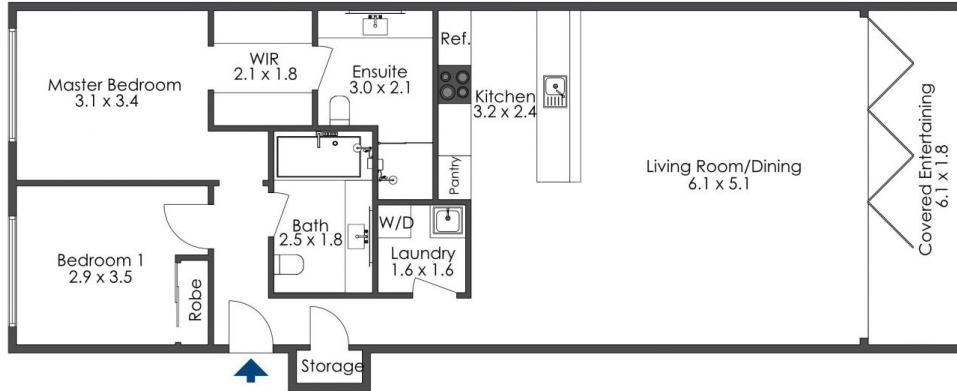

## 6/2A Campbell Parade Manly Vale

The floor plan is not to scale; measurements are indicative and in metres. Exterior elements are not in position. Plans should not be relied on. Interested parties should make and rely on their own enquiries.



## 6/2A Campbell Parade Manly Vale

The floor plan is not to scale; measurements are indicative and in metres. All features included in this 3D plan are for inspiration purposes only. This is not an exact replica of the property or the position of exterior elements. Plans should not be relied on. Interested parties should make and rely on their own enquiries.